

5

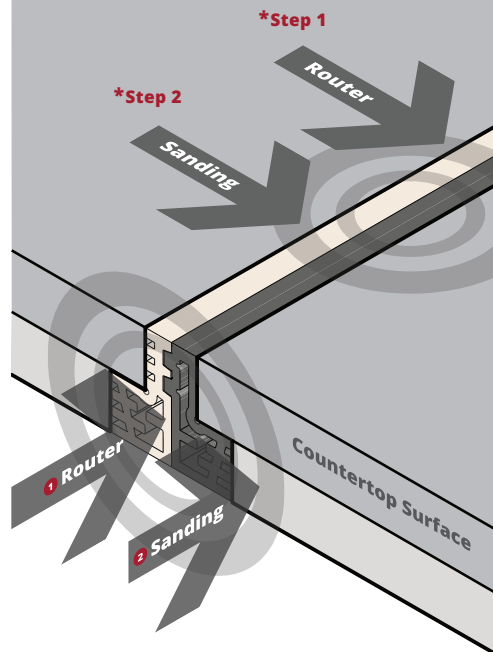

**After checking** both sides are confirmed level, use a router to trim 10/20,000 inch from the top and sides of the seam. After routing, sand the area to achieve a smooth finish. This prepares the Seam-Mate rails for the laminate application.

**\*Step 1: Use a 1" Surface Planing Bit**

6

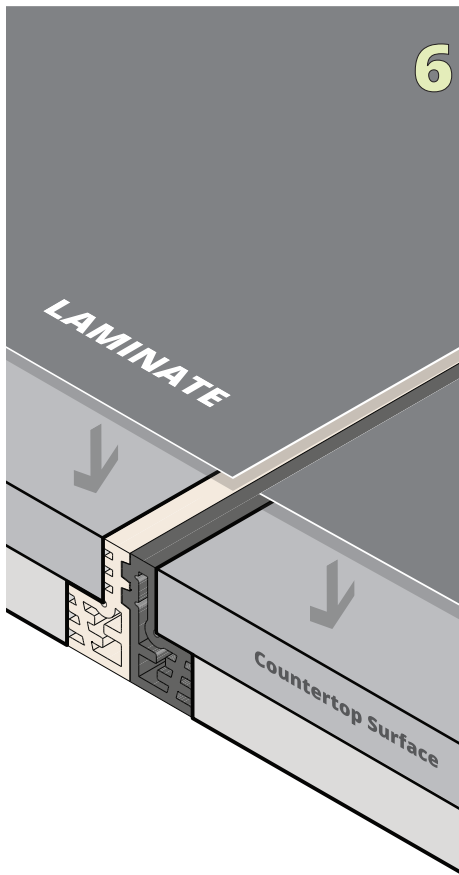

Upon sanding the Seam-Mate rails and smoothing the surface, the laminate is ready for installation.

7

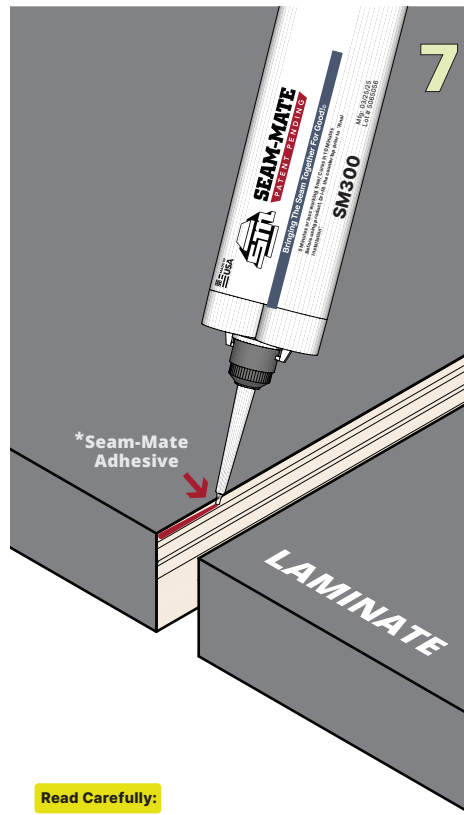

#### Read Carefully:

**Step 7:** Before the final installation, Dri-Fit the countertop to ensure proper alignment. Ensure the area beneath the clips is properly positioned for easy installation. Apply a bead of adhesive to the top "Tan" rail groove as shown. Close the seam and attach the clips for final securing. Remove any excess adhesive and clean the surface.

(Adhesive has 5 minutes of working time and 12-15 minutes of cured time.)



# SEAM-MATE

PATENT PENDING

Bringing The Seam Together For Good!®

## Instruction Manual

### Kit Includes:

Each 64" Seam-Mate pair will make one 37" 45-degree & one 27" 90-degree seam.

### Kits Include:

- 2 - 64" Seam-Mate rails (1 pair)
- 1 - Bag #6 1-1/4" screws (50 pcs)
- 10 - Seam-Mate Finishing Clips
- 1 - 50ml 2 part Seam-Mate Adhesive
- 6 - Mixing stems



For more information, Please visit  
**seam-mate.com**  
or call us:  
**440-548-1548**



**Safety Disclaimer**

Please use safety glasses or face protection when installing Seam-Mate products.

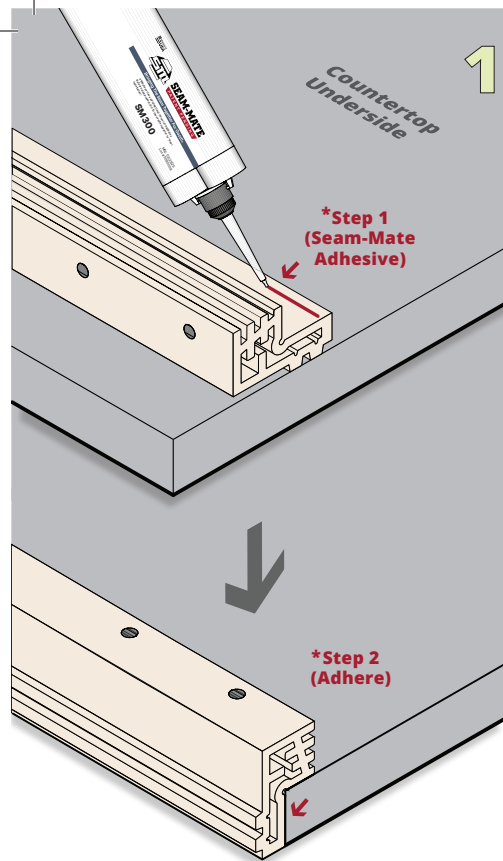

Apply Seam-Mate adhesive to the backside of each Seam-Mate rail. Attach the rails to both countertop ends that will be joined together.

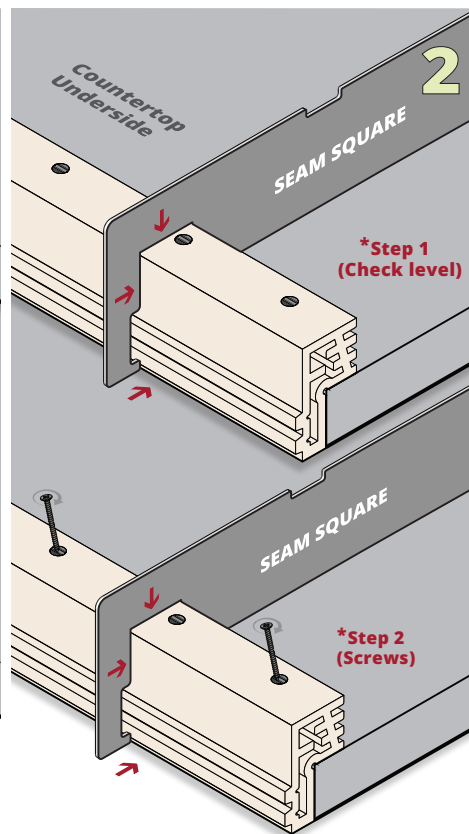

Use the Seam-Mate Level and screw the center of each rail first. Check for level as you go, then alternate screwing one end at a time. Continue installing the remaining screws. Do this for both Tan and Black rails. Ensure that both ends of the Seam-Mate rails are aligned with the countertop edges.

(Make sure both ends of the Seam-Mate rails align evenly with the ends of the Countertop.)

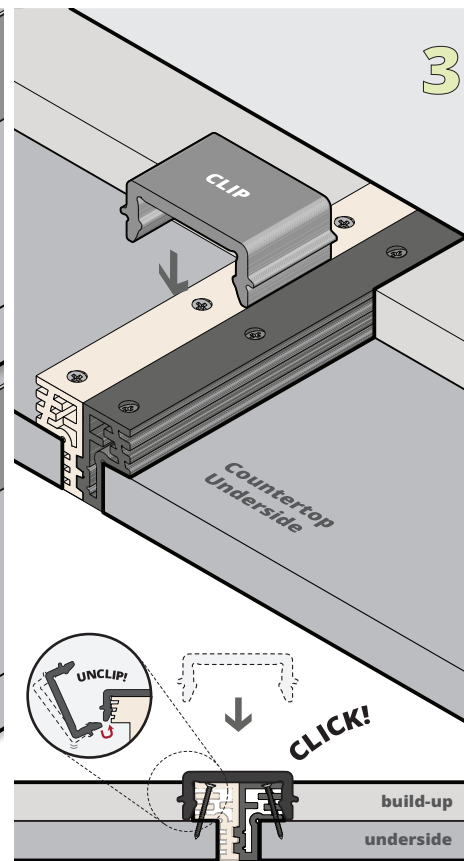

Flip the countertop over. Close the seams together and lock them in place using Seam-Mate clips.

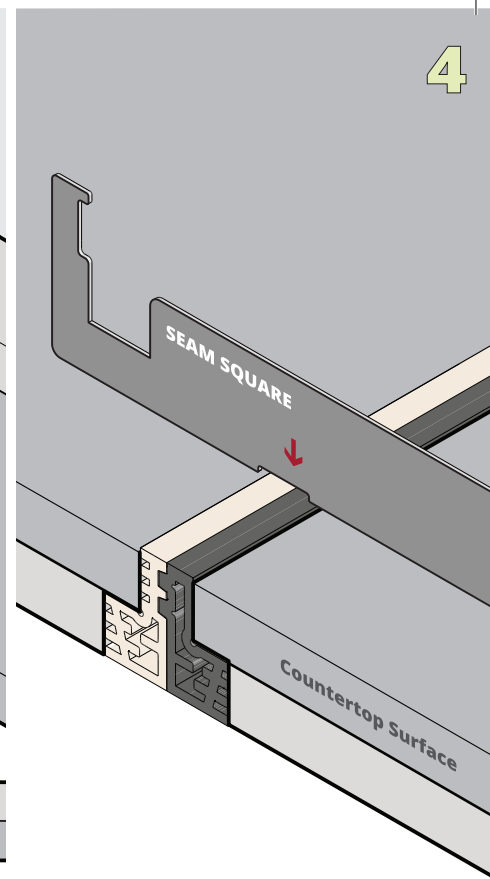

Use the Seam-Mate Level by running the open center down both rails to ensure the wood on either side of the rail system is true and level.